



## Pressure Transmitter with Digital Display



measuring  
•  
monitoring  
•  
analysing

### PDA



PDA-25

PDA-35



PDA-15

- Measuring range:  
-1...0 to 0...700 bar
- Measuring span  
from 600 mbar
- Temperature: max. 80 °C
- Accuracy:  
±0,5% of full scale  
(±1,0% of full scale)
- Housing material:  
stainless steel
- Connection:  
G 1/4, G 1/2,  
1/4" NPT or 1/2" NPT



P2

KOBOLD companies worldwide:

AUSTRALIA, AUSTRIA, BELGIUM, BULGARIA, CANADA, CHINA, CZECHIA, EGYPT, FRANCE, GERMANY, GREAT BRITAIN, HUNGARY, INDIA, INDONESIA, ITALY, MALAYSIA, MEXICO, NETHERLANDS, PERU, POLAND, REPUBLIC OF KOREA, ROMANIA, RUSSIA, SPAIN, SWITZERLAND, THAILAND, TUNISIA, TURKEY, USA, VIETNAM

KOBOLD Messring GmbH  
Nordring 22-24  
D-65719 Hofheim/Ts.  
Head Office:  
+49(0)6192 299-0  
+49(0)6192 23398  
info.de@kobold.com  
www.kobold.com



## Pressure Transmitter with Digital Display Model PDA

### Description

KOBOLD pressure transmitter series PDA are cost effective electronic pressure transmitters with digital indication of actual pressure. An analogue output (0)4- 20 mA is available for remote transmission of the measured value. The device is also available with a switch output as well.

A piezzo resistive ceramic sensor is used. The units can be used where high switching accuracy is needed. Long term stability, repeatability and the compact and robust design makes them ideal for use in OEM applications.

### Dimensions

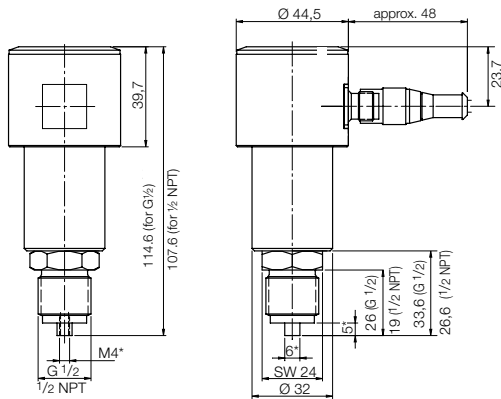

\* No nipple on NPT thread  
(dimensions G 1/4 male on request)

### Applications

- Compressors
- Machinery industry
- Installations
- Pumps

### Technical Details

- Housing: stainless steel 1.4305  
 Anschlüsse: G 1/4 or G 1/2 male, stainless steel 1.4404  
 option 1/4" or 1/2" NPT, others on request  
 Gasket: FPM (Option: EPDM)  
 Sensor element: piezzo resistive ceramic cell  
 Indication: 3-digit LED, height 7 mm  
 Resolution: max. 0,01 bar (depending on measuring range and measured value)  
 Max. temperature: media: -20...+80°C  
 ambient: -20...+80°C  
 Max. over pressure: up to 60 bar: 3 times  
 from 100 bar: 2 times of the range  
 400 bar: 1.5 times of the range  
 Supply voltage: 24 V<sub>DC</sub> ± 20 %  
 Power consumption: approx. 120 mA  
 (without switching output)  
 Electr. connection: plug M12x1  
 Settings (standard): programmable via 2 buttons
- switching point
  - hysteresis
  - 4-20 mA or 0-20 mA
  - start point / end point (current)
  - filter
  - zero point
  - security code
- Overrange/underrange indication.: on LED-display  
 Load: max. 500 Ω  
 Switching output: PNP or NPN semiconductor (factory set), max. 300 mA, short-circuit proof  
 N/O or N/C, programmable  
 Contact: 1 LED  
 Output indicator: 1 LED  
 ON/OFF-switch. delay: 0,5...99,5 s (separately adjustable)  
 Response time: 0,5 s  
 Accuracy: ±0,5 % of f. s. (± 1,0 % of f. s. for measuring range: ≤ 1,6 bar)  
 Protection: IP 65

### Order Details (Example: PDA-15 3 R2 C315)

Model	Description	Output	Electrical connection	Mechanical connection	Measuring range [bar]	Measuring range [PSI]
PDA-	Pressure transmitter with digital display	15 = standard 0(4) - 20 mA 25 = 0(4) - 20 mA, PNP-Switching output 35 = 0(4) - 20 mA, NPN-Switching output	3 = plug M12x1	R2 = G 1/4 R4 = G 1/2 N2 = 1/4" NPT N4 = 1/2" NPT	C315 = -1 - 0 B025 = 0 - 1 B035 = 0 - 1,6 B045 = 0 - 2,5 B055 = 0 - 4 B065 = 0 - 6 B075 = 0 - 10 B085 = 0 - 16 A095 = 0 - 25 A105 = 0 - 40 A115 = 0 - 60 A125 = 0 - 100 A135 = 0 - 160 A145 = 0 - 250 A155 = 0 - 400 A165 = 0 - 600 A167 = 0 - 700	H315 = -30 - 0 in Hg P025 = 0 - 15 P045 = 0 - 30 P055 = 0 - 50 P065 = 0 - 100 P075 = 0 - 150 P085 = 0 - 200 P095 = 0 - 350 P105 = 0 - 600 P115 = 0 - 1000 P125 = 0 - 1450 P135 = 0 - 3200 P145 = 0 - 3600 P155 = 0 - 5800 YYY = Special

### Additional: Electrical connection

Description	Model
M12x1 socket with 2 m cable	ZUB-KAB-12K002
M12x1 socket with Quickon-plug	ZUB-KAB-12Q000